

ACS

330 bar

- Maximum pressure 330 bar
 Extreme operating temperatures:
 - standard version - 20°C to + 120°C
 - **low** temperature version - 40°C to + 120°C

ACSL

210 bar

- Maximum pressure 210 bar
 Extreme operating temperatures:
 - standard version - 20°C à + 100°C
 - **low** temperature version - 40°C à + 100°C

■ Technical description

The ACS-ACSL type welded accumulators are made up of a shell in high resistance steel containing a fluid-gas separator. This separator is made of nitrile for the standard ACS range, and of hydrogenated nitrile for low temperature applications. The separator is fitted with an anti-extrusion stud, thus allowing rapid and total discharge of the accumulator.

■ Advantages

- Low temperature versions suitable for operation at temperatures down to - 40°C.
- Interchangeable, given outer dimensions, with most accumulators available.
- Completely modular from 0.7 to 4 litres. This design concept means easy addition of intermediate models if required.
- The bladder offers exceptionally good resistance to fatigue.
- Rapid and total discharge possible due to the anti-extrusion stud actually fitted onto the bladder.

■ Gas charging

- Two versions of the ACS-ACSL are available:
- with a charging screw,
 - with a charging valve.

■ Examples of applications

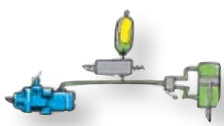

Energy storage



Suspension

■ Deformation of the bladder

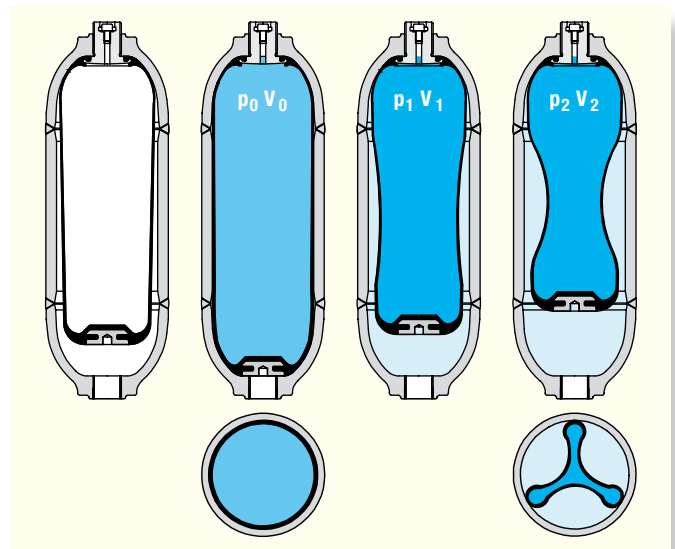

■ Filling gas

Nitrogen only.

■ Operating fluids

- Mineral-based hydraulic fluids.
- Other fluids: please ask.

■ Volumetric ratio $(V_0 - V_2)/V_0$

The recommended volumetric ratio of this type of accumulator is 0.75. For example: an ACS 4 accumulator can take in a maximum volume of $0.75 V_0 = 0.75 \times 4 = 3$ litres.

■ Accessories

- Safety blocks, see pages 12 and 13.
- Fixation devices, see page 11.
- Adaptateurs, voir page 11.

■ Order codes

See page 3.

Hydro-pneumatic accumulators welded cylindrical

ACS - ACSL

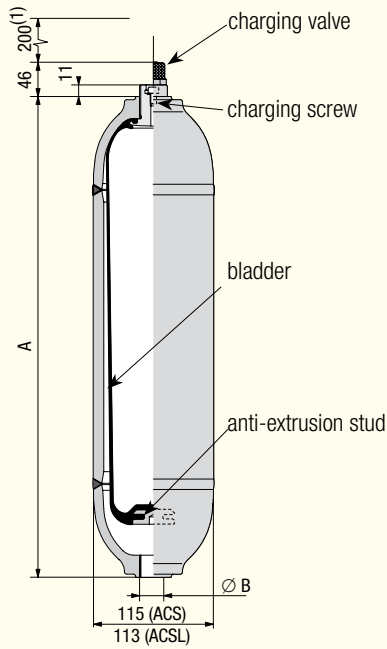

(1) dimensions with VGL 4 fitted

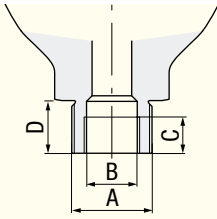

Leduc part n°	A	B	C	D
ACS 0,7 066695	M33 x 1.5	G1/2"	14	20
ACS 0,7 066735	M26 x 1.5	M14 x 1.5	14	16

For other oil side threads, please contact our Customer Service Department.



(1) US version.
(2) on request: P1620 valve.

* Other oil side threads can be offered on request.

ACS	reference	nitrogen capacity V ₀ litres	maximum pressure bar CE	weight kg	A mm	oil side thread Ø B	gas side orifice
ACS0.7	066445	0.7	330	4	176	G3/8"	vis
	065975	0.7	330	4	176	G3/8"	valveP1620
	066035	0.7	330	4	176	G3/4"	vis
	066130	0.7	330	4	176	G1/2"	vis
	066255	0.7	330	4	176	G1/2"	valveP1620
	065950	0.7	330	4	176	M16 x 1,5	vis
	065952	0.7	330	4	176	M18 x 1,5	vis
	066845 ⁽¹⁾	0.7	330	4	176	3/4-16UNF-2B(SAE8) ⁽¹⁾	vis
	065947 ⁽¹⁾	0.7	330	4	176	3/4-16UNF-2B(SAE8) ⁽¹⁾	valveSCHRADER
ACS1	065960	1.1	330	5,9	246	G3/4"	vis
	065976	1.1	330	5,9	246	G3/4"	valveP1620
	065964	1.1	330	5,9	246	M18 x 1,5	vis
	066855 ⁽¹⁾	1.1	330	5,9	246	3/4-16UNF-2B(SAE8) ⁽¹⁾	vis
	065965 ⁽¹⁾	1.1	330	5,9	246	3/4-16UNF-2B(SAE8) ⁽¹⁾	valveSCHRADER
ACS1,5	065940	1.5	330	7,8	315	G3/4"	vis
	065977	1.5	330	7,8	315	G3/4"	valveP1620
	066840	1.5	330	7,8	315	M18 x 1,5	vis
	065945 ⁽¹⁾	1.5	330	7,8	315	3/4-16UNF-2B(SAE8) ⁽¹⁾	valveSCHRADER
	066865 ⁽¹⁾	1.5	330	7,8	315	3/4-16UNF-2B(SAE8) ⁽¹⁾	vis
ACS2	066705	2	330	9,9	393	G3/4"	vis
	066675	2	330	9,9	393	G3/4"	valveP1620
ACS2,5	065910	2.5	330	11,5	464	G3/4"	vis
	065978	2.5	330	11,5	464	G3/4"	valveP1620
	066875 ⁽¹⁾	2.5	330	11,5	464	3/4-16UNF-2B(SAE8) ⁽¹⁾	vis
	065915 ⁽¹⁾	2.5	330	11,5	464	3/4-16UNF-2B(SAE8) ⁽¹⁾	valveSCHRADER
	066685 ⁽¹⁾	2.5	330	11,5	464	1"1/16-12UN-2B(SAE12) ⁽¹⁾	valveSCHRADER
ACS4	065920	4	330	17,5	696	G3/4"	vis
	065979	4	330	17,5	696	G3/4"	valveP1620
	066885 ⁽¹⁾	4	330	17,5	696	3/4-16UNF-2B(SAE8) ⁽¹⁾	vis
	065925 ⁽¹⁾	4	330	17,5	696	3/4-16UNF-2B(SAE8) ⁽¹⁾	valveSCHRADER
	066690 ⁽¹⁾	4	330	17,5	696	1"1/16-12UN-2B(SAE12) ⁽¹⁾	valveSCHRADER

ACSL*	reference	nitrogen capacity V ₀ litres	maximum pressure bar CE	weight kg	A mm	oil side thread Ø B	gas side orifice
ACSL0.7	068125	0.7	210	3	175	G1/2"	vis ⁽²⁾
	068275	0.7	210	3	175	3/4-16UNF-2B(SAE8) ⁽¹⁾	vis ⁽²⁾
	068385	0.7	210	3	175	M18x1.5	vis ⁽²⁾
	068440	0.7	210	3	175	M18x1.5	ValveP1620
ACSL1	068130	0.99	210	4.5	245	G3/4"	vis ⁽³⁾
	068160	0.99	210	4.5	245	G1/2"	vis ⁽³⁾
	068280	0.99	210	4.5	245	3/4-16UNF-2B(SAE8) ⁽¹⁾	vis ⁽³⁾
	068395	0.99	210	4.5	245	M18x1.5	vis ⁽³⁾
	068445	0.99	210	4.5	245	M18x1.5	ValveP1620
ACSL1.5	068135	1.5	210	5.9	315	G3/4"	vis ⁽³⁾
	068410	1.5	210	5.9	315	3/4-16UNF-2B(SAE8) ⁽¹⁾	vis ⁽³⁾
	068450	1.5	210	5.9	315	M18x1.5	ValveP1620
ACSL2	068140	2	210	7.6	392	G3/4"	vis ⁽³⁾
	068525	2	210	7.6	392	M18x1.5	vis ⁽³⁾
	068455	2	210	7.6	392	3/4-16UNF-2B(SAE8) ⁽¹⁾	ValveP1620
ACSL2.5	068145	2.5	210	8.9	463	G3/4"	vis ⁽³⁾
	068530	2.5	210	8.9	463	1"1/16-12UNF-2B(SAE12) ⁽¹⁾	vis ⁽³⁾
	068460	2.5	210	8.9	463	M18x1.5	ValveP1620
ACSL4	068390	4	210	13.9	695	G3/4"	vis ⁽³⁾
	068535	4	210	13.9	695	1"1/16-12UNF-2B(SAE12) ⁽¹⁾	vis ⁽³⁾
	068465	4	210	13.9	695	M18x1.5	ValveP1620