

PAM type. Piston accumulator

Technical data

Operating pressure:
PAM 250 max 250 bar
PAM 350-415 max 350-415 bar

Gas filling (nitrogen only): max. 90% of min. operating pressure
Admissible pressure ratio: -
Operating temperature: -40 +100°C
Technical data any position

Standard construction characteristics

Material of body:
PAM 250 carbon steel, stainless steel AISI 316L
PAM 350-415 carbon steel, stainless steel AISI 316L
Gasket: NBR + polyamide
Gas connection valve: 5/8" UNF version 1
Painting: anti-rust primer (only carbon steel)
Test: on request
Standard design: piston speed 0,5 m/s
Special design on request: piston speed 3 m/s

PAM 250

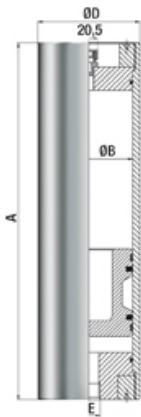

Type	Nominal volume cm ³	Pressure max bar	P.F.C. E	Gas valve	Dimensions mm			Weight kg
					A	ØB	ØD	
PAM 20,4	400	250	3/4" Gas	5/8" UNF	212	-	-	-
PAM 0.5	500	250	3/4" Gas	5/8" UNF	233	-	-	-
PAM 13- Dec	750	250	3/4" Gas	5/8" UNF	282	-	-	-
PAM 1	1000	250	3/4" Gas	5/8" UNF	332	-	-	-
PAM 2	2000	250	3/4" Gas	5/8" UNF	531	-	-	-
PAM 3	3000	250	3/4" Gas	5/8" UNF	730	-	-	-
PAM 4	4000	250	3/4" Gas	5/8" UNF	929	-	-	-
PAM 2	2000	250	1" Gas	5/8" UNF	419	-	-	-
PAM 3	3000	250	1" Gas	5/8" UNF	546	-	-	-
PAM 4	4000	250	1" Gas	5/8" UNF	674	-	-	-
PAM 6	6000	250	1" Gas	5/8" UNF	928	-	-	-
PAM 8	8000	250	1" Gas	5/8" UNF	1183	-	-	-
PAM 10	10000	250	1" Gas	5/8" UNF	1437	-	-	-
PAM 4	4000	250	1" 1/2 Gas	5/8" UNF	449	-	-	-
PAM 6	6000	250	1" 1/2 Gas	5/8" UNF	579	-	-	-
PAM 7	7000	250	1" 1/2 Gas	5/8" UNF	644	-	-	-
PAM 8	8000	250	1" 1/2 Gas	5/8" UNF	709	-	-	-
PAM 10	10000	250	1" 1/2 Gas	5/8" UNF	839	-	-	-
PAM 12	12000	250	1" 1/2 Gas	5/8" UNF	968	-	-	-
PAM 15	15000	250	1" 1/2 Gas	5/8" UNF	11163	-	-	-
PAM 20	20000	250	1" 1/2 Gas	5/8" UNF	1488	-	-	-
PAM 5	5000	250	1" 1/2 Gas	5/8" UNF	436	-	-	-
PAM 10	10000	250	1" 1/2 Gas	5/8" UNF	685	-	-	-
PAM 15	15000	250	1" 1/2 Gas	5/8" UNF	934	-	-	-
PAM 20	20000	250	1" 1/2 Gas	5/8" UNF	11182	-	-	-
PAM 25	25000	250	1" 1/2 Gas	5/8" UNF	1431	-	-	-
PAM 30	30000	250	1" 1/2 Gas	5/8" UNF	1680	-	-	-
PAM 8	8000	250	2" Gas	5/8" UNF	503	-	-	-
PAM 10	10000	250	2" Gas	5/8" UNF	566	-	-	-
PAM 15	15000	250	2" Gas	5/8" UNF	725	-	-	-
PAM 20	20000	250	2" Gas	5/8" UNF	885	-	-	-
PAM 25	25000	250	2" Gas	5/8" UNF	1044	-	-	-
PAM 30	30000	250	2" Gas	5/8" UNF	1203	-	-	-
PAM 45	45000	250	2" Gas	5/8" UNF	1680	-	-	-
PAM 50	50000	250	2" Gas	5/8" UNF	1840	-	-	-
PAM 10	10000	250	2" Gas	5/8" UNF	461	-	-	-
PAM 20	20000	250	2" Gas	5/8" UNF	664	-	-	-
PAM 30	30000	250	2" Gas	5/8" UNF	868	-	-	-
PAM 40	40000	250	2" Gas	5/8" UNF	1072	-	-	-
PAM 50	50000	250	2" Gas	5/8" UNF	1275	-	-	-
PAM 60	60000	250	2" Gas	5/8" UNF	1479	-	-	-
PAM 70	70000	250	2" Gas	5/8" UNF	1683	-	-	-
PAM 80	80000	250	2" Gas	5/8" UNF	1886	-	-	-

Stainless
steel
Carbon
steel

PAM type. Piston accumulator

Technical data

Operating pressure:
PAM 250 max 250 bar
PAM 350-415 max 350-415 bar

Gas filling (nitrogen only): max. 90% of min. operating pressure
Admissible pressure ratio: -
Operating temperature: -40 +100°C
Technical data any position

Standard construction characteristics

Material of body:
PAM 250 carbon steel, stainless steel AISI 316L
PAM 350-415 carbon steel, stainless steel AISI 316L
Gasket: NBR + polyamide
Gas connection valve: 5/8" UNF version 1
Painting: anti-rust primer (only carbon steel)
Test: on request
Standard design: piston speed 0,5 m/s
Special design on request: piston speed 3 m/s

PAM 350-415

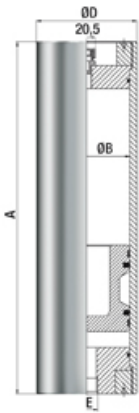

Type	Nominal volume cm ³	Pressure		P.F.C.	Gas valve	Dimensions mm			Weight kg
		max	bar			A	ØB	ØD	
PAM 70,4	400	350	415	3/4" Gas	5/8" UNF	254	-	-	-
PAM 0.5	500	350	415	3/4" Gas	5/8" UNF	274	-	-	-
PAM 13- Dec	750	350	415	3/4" Gas	5/8" UNF	323	-	-	-
PAM 1	1000	350	415	3/4" Gas	5/8" UNF	373	-	-	-
PAM 2	2000	350	415	3/4" Gas	5/8" UNF	572	-	-	-
PAM 3	3000	350	415	3/4" Gas	5/8" UNF	771	-	-	-
PAM 4	4000	350	415	3/4" Gas	5/8" UNF	970	-	-	-
PAM 2	2000	350	415	1" Gas	5/8" UNF	457	-	-	-
PAM 3	3000	350	415	1" Gas	5/8" UNF	584	-	-	-
PAM 4	4000	350	415	1" Gas	5/8" UNF	712	-	-	-
PAM 6	6000	350	415	1" Gas	5/8" UNF	966	-	-	-
PAM 8	8000	350	415	1" Gas	5/8" UNF	1221	-	-	-
PAM 10	10000	350	415	1" Gas	5/8" UNF	1475	-	-	-
PAM 4	4000	350	415	1 1/2" Gas	5/8" UNF	517	-	-	-
PAM 6	6000	350	415	1 1/2" Gas	5/8" UNF	647	-	-	-
PAM 7	7000	350	415	1 1/2" Gas	5/8" UNF	712	-	-	-
PAM 8	8000	350	415	1 1/2" Gas	5/8" UNF	777	-	-	-
PAM 10	10000	350	415	1 1/2" Gas	5/8" UNF	907	-	-	-
PAM 12	12000	350	415	1 1/2" Gas	5/8" UNF	1036	-	-	-
PAM 15	15000	350	415	1 1/2" Gas	5/8" UNF	1231	-	-	-
PAM 20	20000	350	415	1 1/2" Gas	5/8" UNF	1556	-	-	-
PAM 5	5000	350	415	1 1/2" Gas	5/8" UNF	467	-	-	-
PAM 10	10000	350	415	1 1/2" Gas	5/8" UNF	715	-	-	-
PAM 15	15000	350	415	1 1/2" Gas	5/8" UNF	964	-	-	-
PAM 20	20000	350	415	1 1/2" Gas	5/8" UNF	1213	-	-	-
PAM 25	25000	350	415	1 1/2" Gas	5/8" UNF	1461	-	-	-
PAM 30	30000	350	415	1 1/2" Gas	5/8" UNF	1710	-	-	-
PAM 8	8000	350	415	2" Gas	5/8" UNF	513	-	-	-
PAM 10	10000	350	415	2" Gas	5/8" UNF	576	-	-	-
PAM 15	15000	350	415	2" Gas	5/8" UNF	735	-	-	-
PAM 20	20000	350	415	2" Gas	5/8" UNF	895	-	-	-
PAM 25	25000	350	415	2" Gas	5/8" UNF	1054	-	-	-
PAM 30	30000	350	415	2" Gas	5/8" UNF	1213	-	-	-
PAM 45	45000	350	415	2" Gas	5/8" UNF	1690	-	-	-
PAM 50	50000	350	415	2" Gas	5/8" UNF	1849	-	-	-
PAM 10	10000	350	415	2" Gas	5/8" UNF	491	-	-	-
PAM 20	20000	350	415	2" Gas	5/8" UNF	694	-	-	-
PAM 30	30000	350	415	2" Gas	5/8" UNF	898	-	-	-
PAM 40	40000	350	415	2" Gas	5/8" UNF	1102	-	-	-
PAM 50	50000	350	415	2" Gas	5/8" UNF	1305	-	-	-
PAM 60	60000	350	415	2" Gas	5/8" UNF	1509	-	-	-
PAM 70	70000	350	415	2" Gas	5/8" UNF	1713	-	-	-
PAM 80	80000	350	415	2" Gas	5/8" UNF	1917	-	-	-

Stainless
steel
Carbon
steel